



11 Partington Crescent Binningup, WA

 3
  1
  2

## Easy Summer Living

This property is located in one of Binningup's quietest cul-de-sacs, close to bush reserve and an easy walk to the beach. To top it off, it has an impeccably presented home on a flat block.

Built in 1988 this brick and tile home has been lovingly maintained by the current owners.

The property has:

- Adjacent to the kitchen is a great space for the family dining table.
- The two other bedrooms also have generous proportions with one having a built in robe behind mirrored sliding doors.
- The bathroom is central to the bedrooms and features a fully screened shower recess, bath and large vanity.

- The yard is fully enclosed and is finished off with retained garden beds. Filled with ma

For more details please visit :

<https://www.summitbunbury.com.au/8140926>

**Price:** Offers Above \$499,000  
**Inspect:** Sunday, 6th October 2024 12:00 - 12:45

**Council Rates:** \$2,166.68/year (approx)  
**Water Rates:** \$300.00/year (approx)



**Ruth Nandapi**

0419 955 965

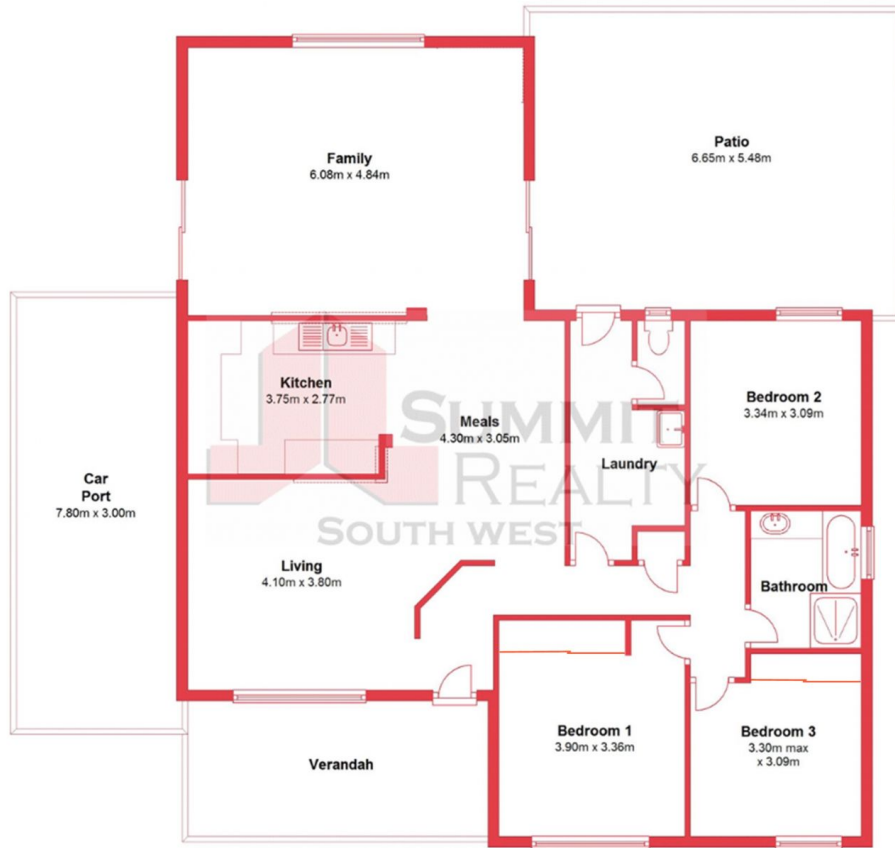

11 Partington Crescent

Binningup, WA

